



55 St. Marychurch Street, London, SE16 4AB

*** WATER INCLUDED *** A beautifully presented two bedrooms, two bathrooms apartment located in the heart of Rotherhithe a short walk away from the Overground station. The property boasts a spacious open plan modern kitchen and reception room with a Juliet balcony, two spacious double bedrooms, one with an en-suite, and a stylish family bathroom. Additional storage can be found in the hallway. This apartment has excellent transport links, both Rotherhithe Overground and Canada Water underground stations, along with being surrounded by a plethora of local amenities such as bars, restaurants, cafes and the greenery of Southwark Park.

- Furnished
- Second Floor Apartment
- Excellent Transport Links
- Plenty of Storage
- Naturally Bright
- Spacious Apartment

Alex & Matteo
ESTATE AGENTS

£2,500 Per month

St. Marychurch Street, London, SE16

Approximate Area = 809 sq ft / 75.1 sq m
For identification only - Not to scale

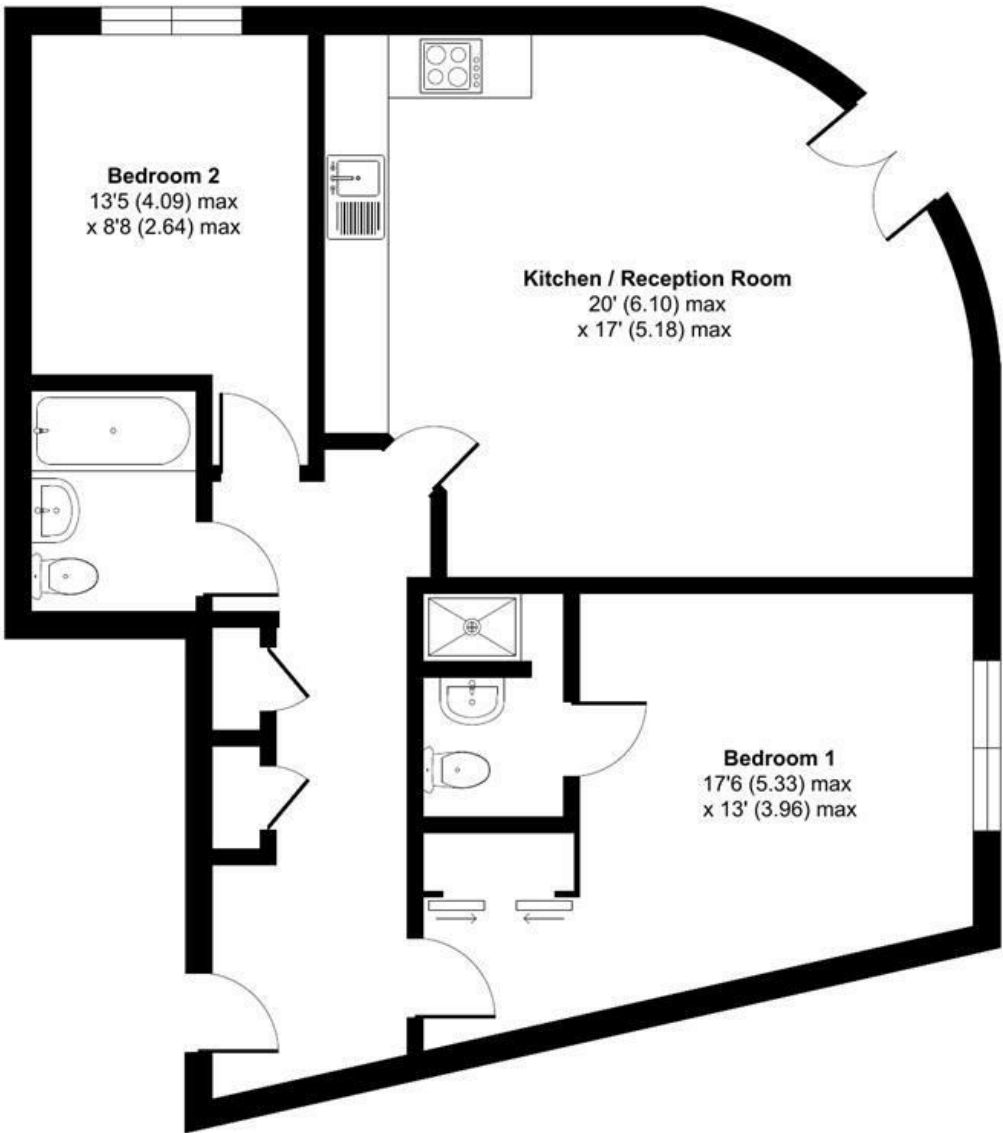

SECOND FLOOR



Certified
Property
Measurer

Floor plan produced in accordance with RICS Property Measurement Standards incorporating International Property Measurement Standards (IPMS2 Residential). © nitchcom 2024. Produced for Alex & Matteo Estate Agents. REF: 1162460

Energy Efficiency Rating		
	Current	Potential
Very energy efficient - lower running costs		
(92 plus) A		
(81-91) B		
(69-80) C	74	75
(55-68) D		
(39-54) E		
(21-38) F		
(1-20) G		
Not energy efficient - higher running costs		
England & Wales		
EU Directive 2002/91/EC		